



Janakkala Vähä-Hiisi 2 a  
Kreetta Lesell 2008

Yleiskartta  
MK 1: 1000



Piirt. & digit.  
Mikko Suha

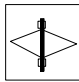
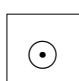

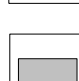
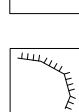
-  Voimalinjapylväs
-  Tulevan pylvään keskikohta
-  Kaivausalueet, koekuopat
-  Rakennus
-  Rinne, viettosuunta

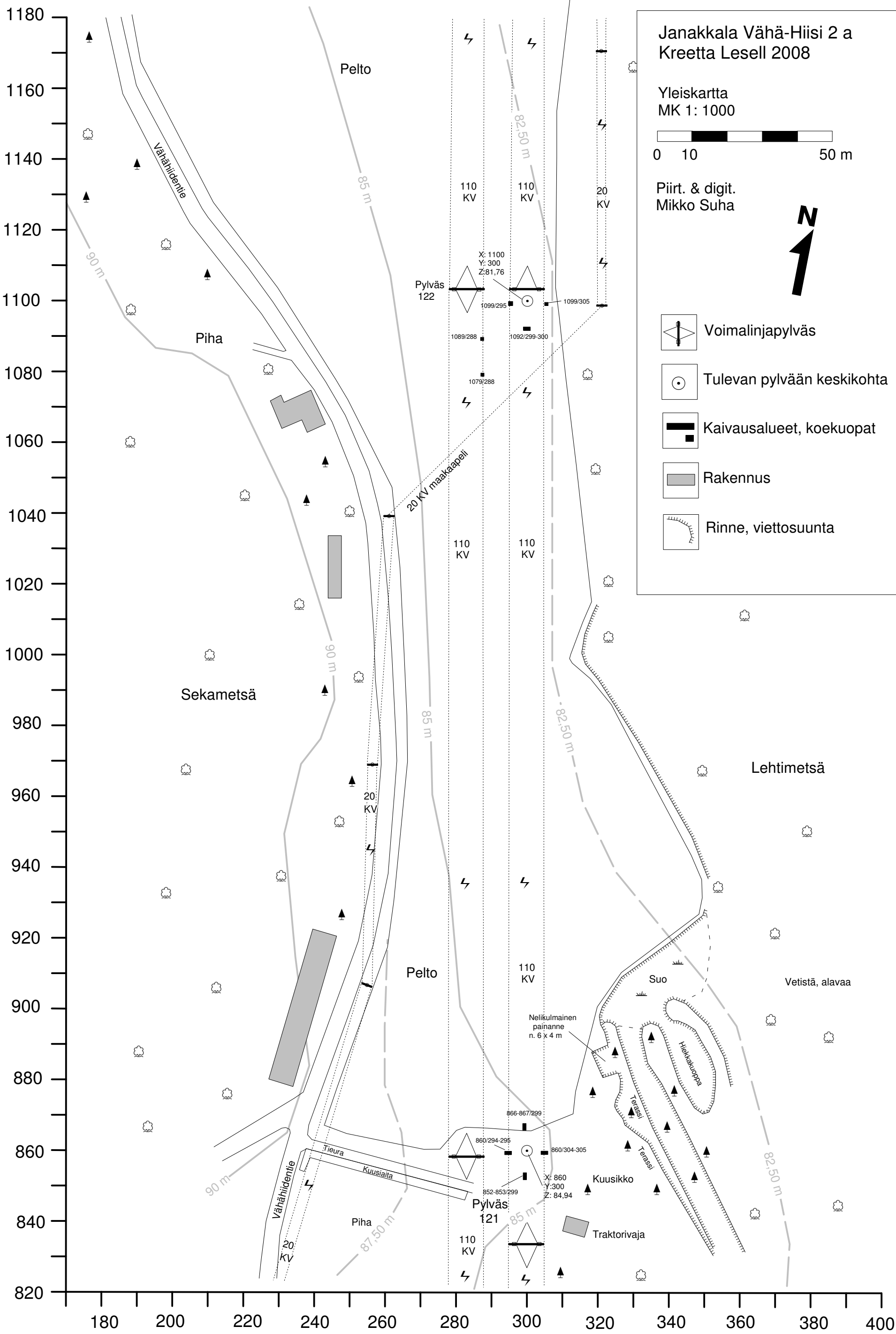



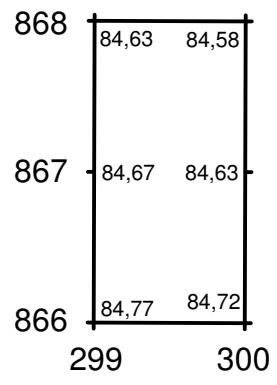

Janakkala Vähä-Hiisi 2 a  
Kreetta Lesell 2008

Pylväs 121

Pintavaaitukset

KP korkeus 84,94 m mpy

MK 1: 50



Piirt. & digit.  
Mikko Suha

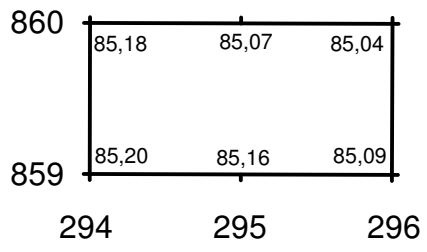

Tulevan pylvään keskikohta

X: 860 +  
Y: 300  
Z: 84,94

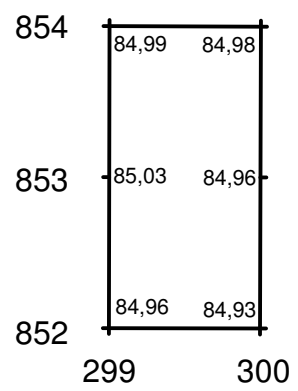
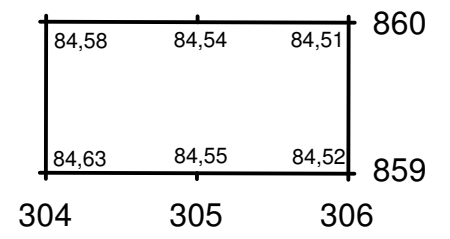

Janakkala Vähä-Hiisi 2 a  
Kreetta Lesell 2008

Pylväs 121

Taso 1

KP korkeus 84,94 m mpy

MK 1: 50



Neulapohjoinen

Piirt. & digit.  
Mikko Suha

hs Harmaa savensekainen hiekka

b Rikastumiskerros, punertava hiekka

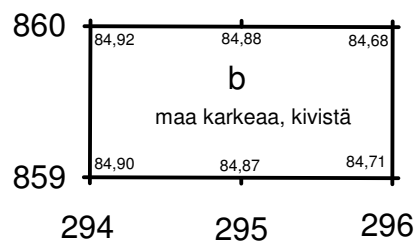
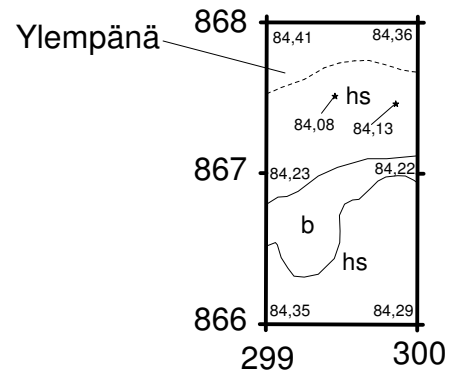

+  
X: 860  
Y: 300  
Z: 84, 94

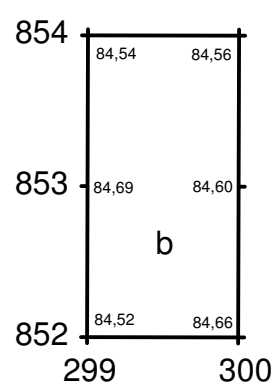
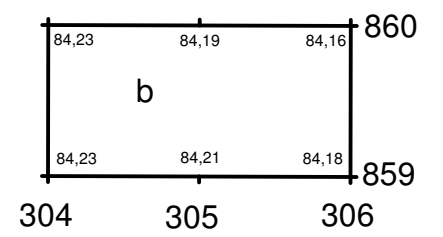

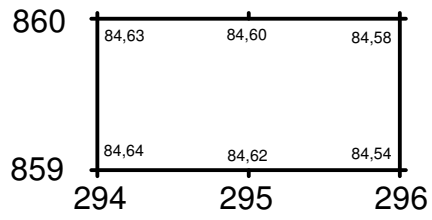

+

X: 860  
Y: 300  
Z: 84,94

Janakkala Vähä-Hiisi 2 a  
Kreetta Lesell 2008

Pylväs 121

Pohjavaaitukset, "Taso 1,5"

Kuopat 866- 867 / 299 sekä  
859 / 304- 305 hylätty tasoon 1

Kp korkeus 84,94 m mpy

MK 1: 50



Piirt. & digit.  
Mikko Suha



Neulapohjoinen

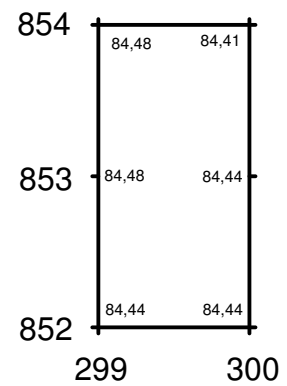

Janakkala Vähä-Hiisi 2 b  
Kreetta Lesell 2008

Pylväs 124  
Alue I  
Pintavaaitus

KP kork. 83,57 m mpy

MK 1: 50

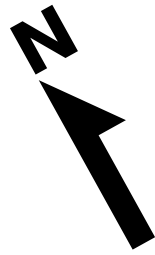
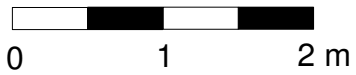

Neulapohjoinen

Piirt. & digit.  
Mikko Suha

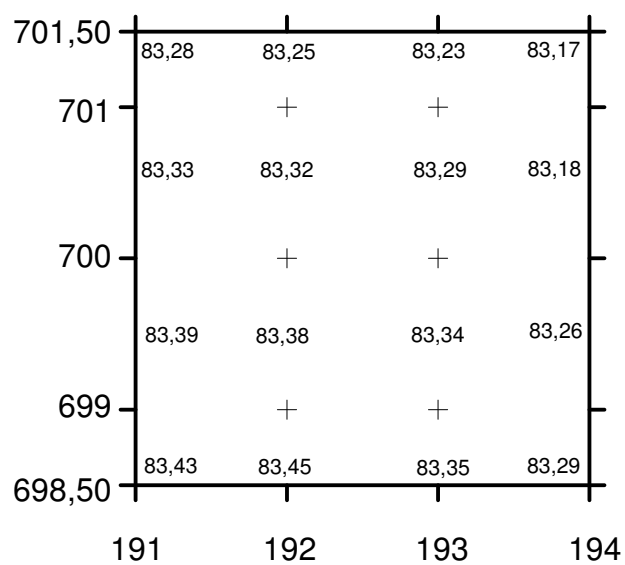

Janakkala Vähä-Hiisi 2 b  
Kreetta Lesell 2008

Pylväs 124  
Alue I  
Taso 0

Kp korkeus 83,57 m mpy

MK 1: 50

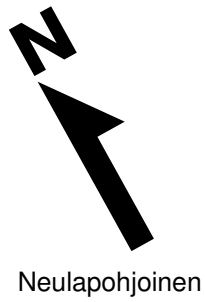
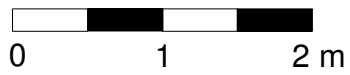

Piirt. & digit.  
Mikko Suha

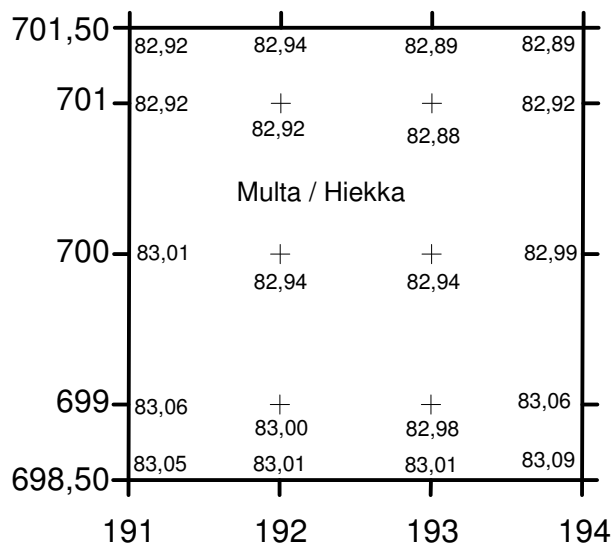

Janakkala Vähä-Hiisi 2 b  
Kreetta Lesell 2008

Pylväs 124  
Alue I  
Taso 1

KP kork. 83,57 m mpy

MK 1: 50

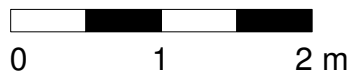

Piirt. & digit.  
Mikko Suha



- a Huuhtoutumiskerros
- b Rikastumiskerros
- m Multa
- Tumma, mullansekainen hiekka
- Juuri
- Kivi
- Tiilenmuru

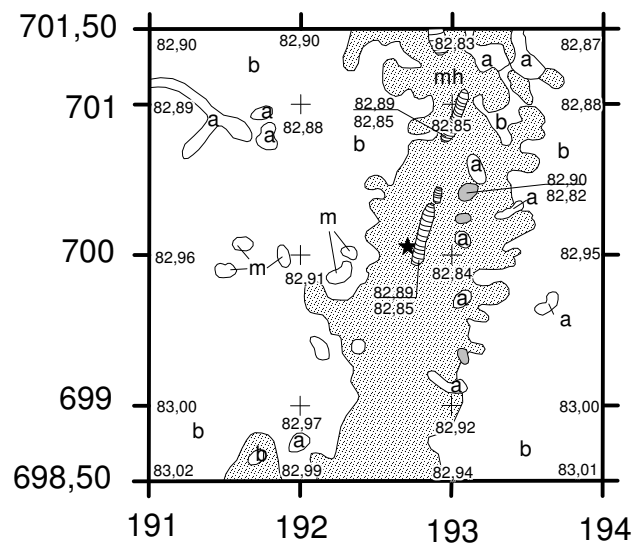



Janakkala Vähä-Hiisi 2 b  
Kreetta Lesell 2008

Pylväs 124  
Alue I  
Taso 2

KP korkeus 83,57 m mpy

MK 1: 50



Piirt. & digit.  
Mikko Suha

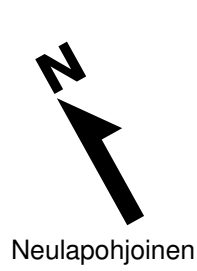

- a Huuhtoutumiskerros
- vb Vaaleahko rikastumiskerros
- Mullan värjäämä tumma hiekka
- Kivi

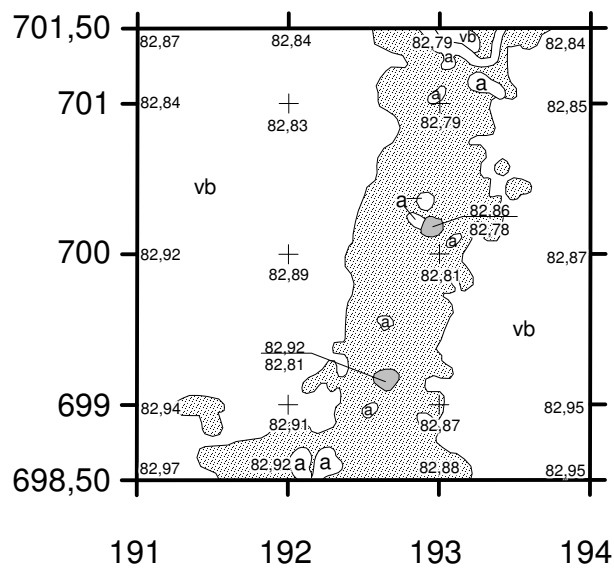

Janakkala Vähä-Hiisi 2 b  
Kreetta Lesell 2008

Pylväs 124

Alue I

Taso 3

KP korkeus 83,57 m mpy

MK 1: 50

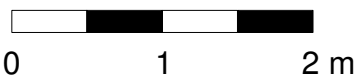

Piirt. & digit.  
Mikko Suha



Mullan värjäämä tumma hiekka



Huuhtoutumiskerros



Vaaleahko rikastumiskerros



Rikastumiskerros

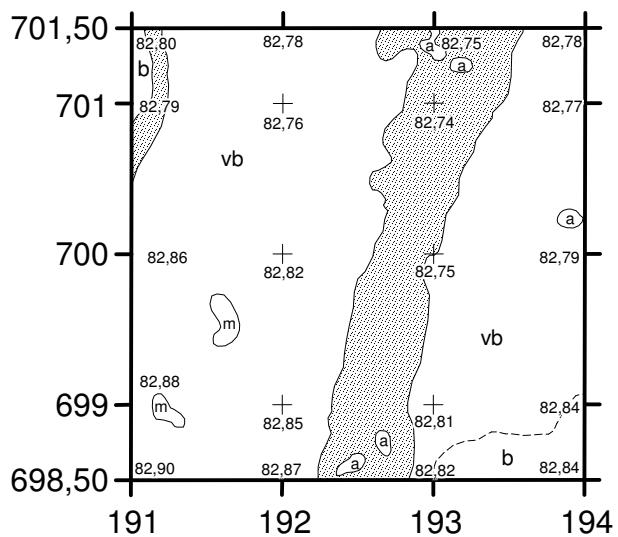

Janakkala Vähä-Hiisi 2 b  
Kreetta Lesell 2008

Pylväs 124

Alue I

Taso 4

KP korkeus 83,57 m mpy

MK 1: 50

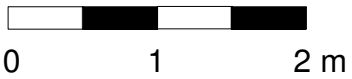

Neulapohjoinen



Mullan värjäämä tumma hiekka



Rikastumiskerros



Vaaleahko rikastumiskerros



Harmahtava pohjahiekka



Multa (myyränkoloja)

Piirt. & digit.  
Mikko Suha

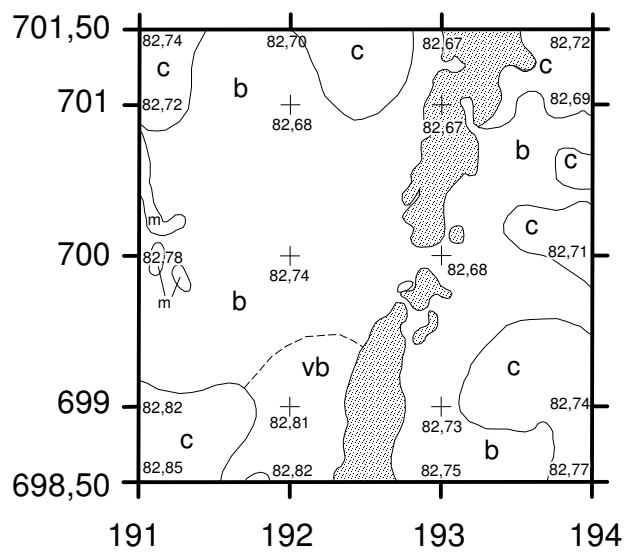

Janakkala Vähä-Hiisi 2 b  
Kreetta Lesell 2008

Pylväs 124  
Alue I  
Pohjavaaitukset

KP korkeus 83,57 m mpy

MK 1: 50

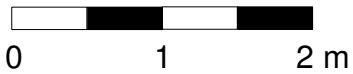

Piirt. & digit.  
Mikko Suha



Neulapohjoinen



Läikän pohja



Harmahtava pohjahiekka

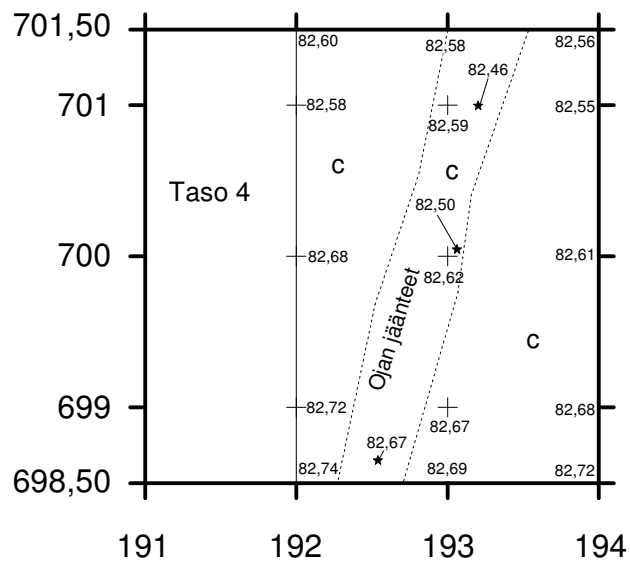

Janakkala Vähä-Hiisi 2 b  
Kreetta Lesell 2008

Pylväs 124

Alue I

Lounaisprofiili linjalla X: 698, 50

Katselusuunta koillisesta

Kp korkeus 83, 57 m mpy

MK 1: 25

0 50 100 cm

Piirt. & digit.  
Mikko Suha



Tumma, mullan värjäämä hiekka



Hieman vaaleampi mullan värjäämä hiekka



m Peltomulta



b Rikastumiskerros, punertava hiekka



vb Vaaleampi rikastumiskerros



c Harmahtava pohjahiekka

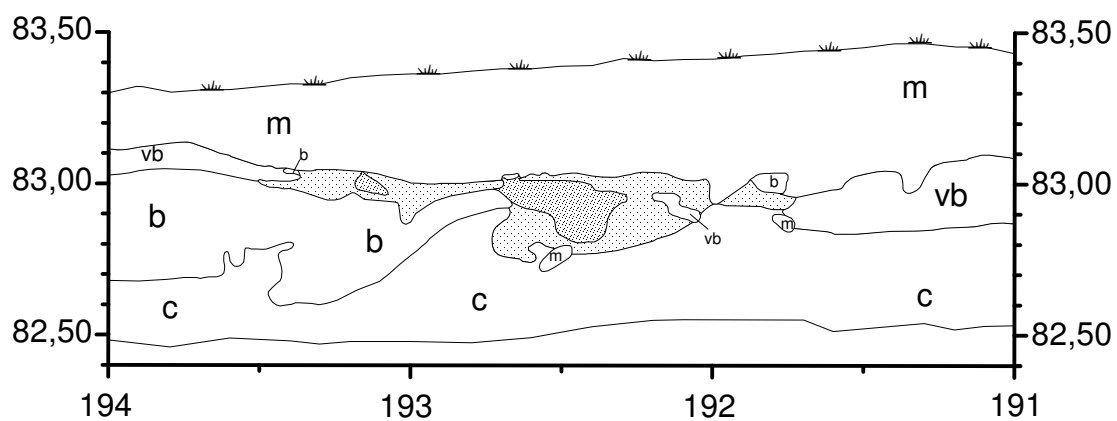

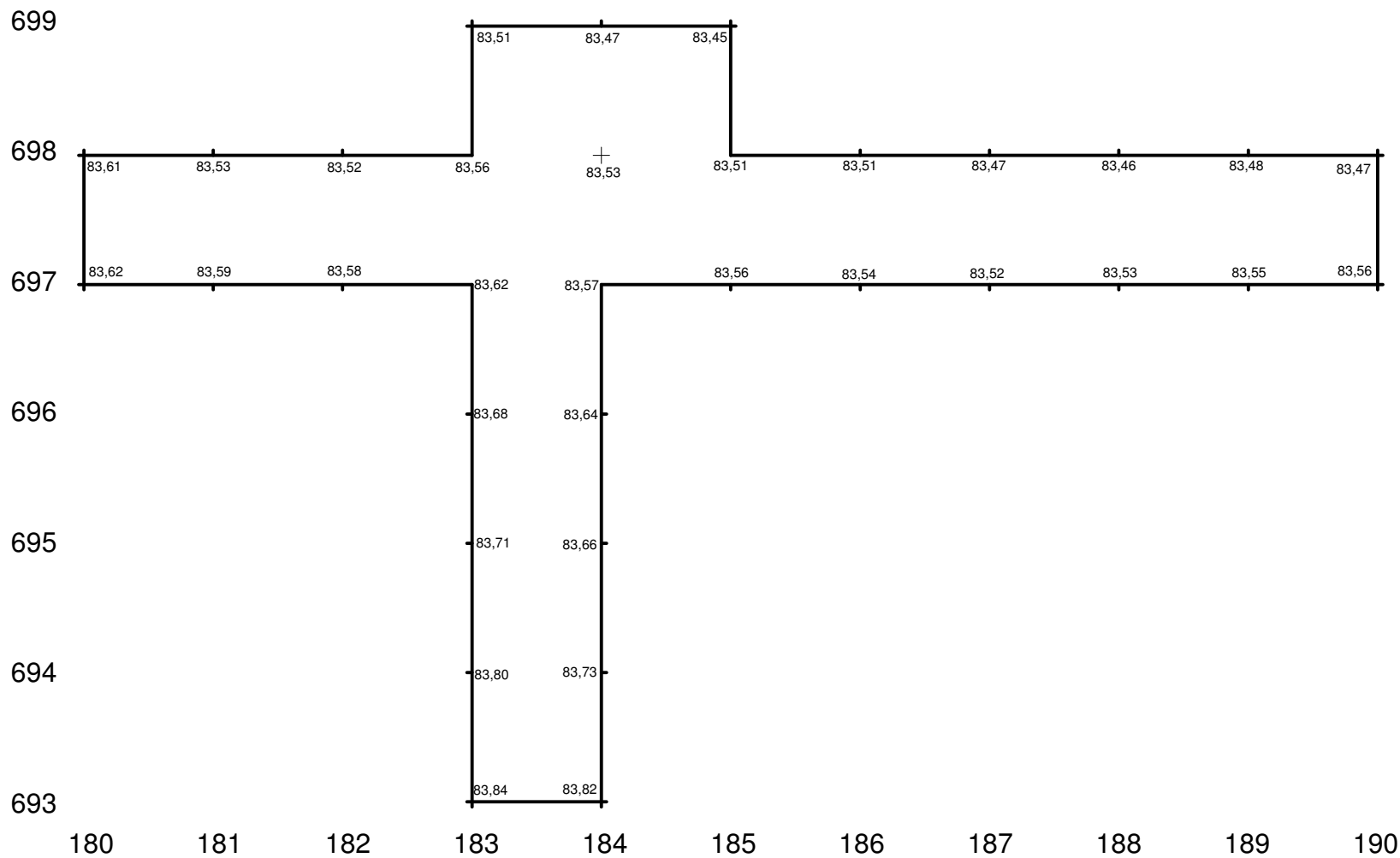

Janakkala Vähä-Hiisi 2 b  
Kreetta Lesell 2008

Pylväs 124  
Alue II  
Pintavaaituskartta

KP korkeus 83,57 m mpy

MK 1: 50



Piirt. & digit.  
Mikko Suha

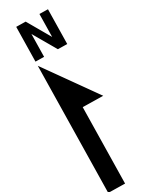

Neulapohjoinen

Janakkala Vähä-Hiisi 2 b  
Kreetta Lesell 2008

Pylväs 124  
Alue II  
Taso 0

KP korkeus 83,57 m mpy

MK 1: 50

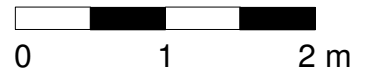

Piirt. & digit.  
Mikko Suha



m Peltomulta

vb Vaalea huuhtoutumis-  
kerros

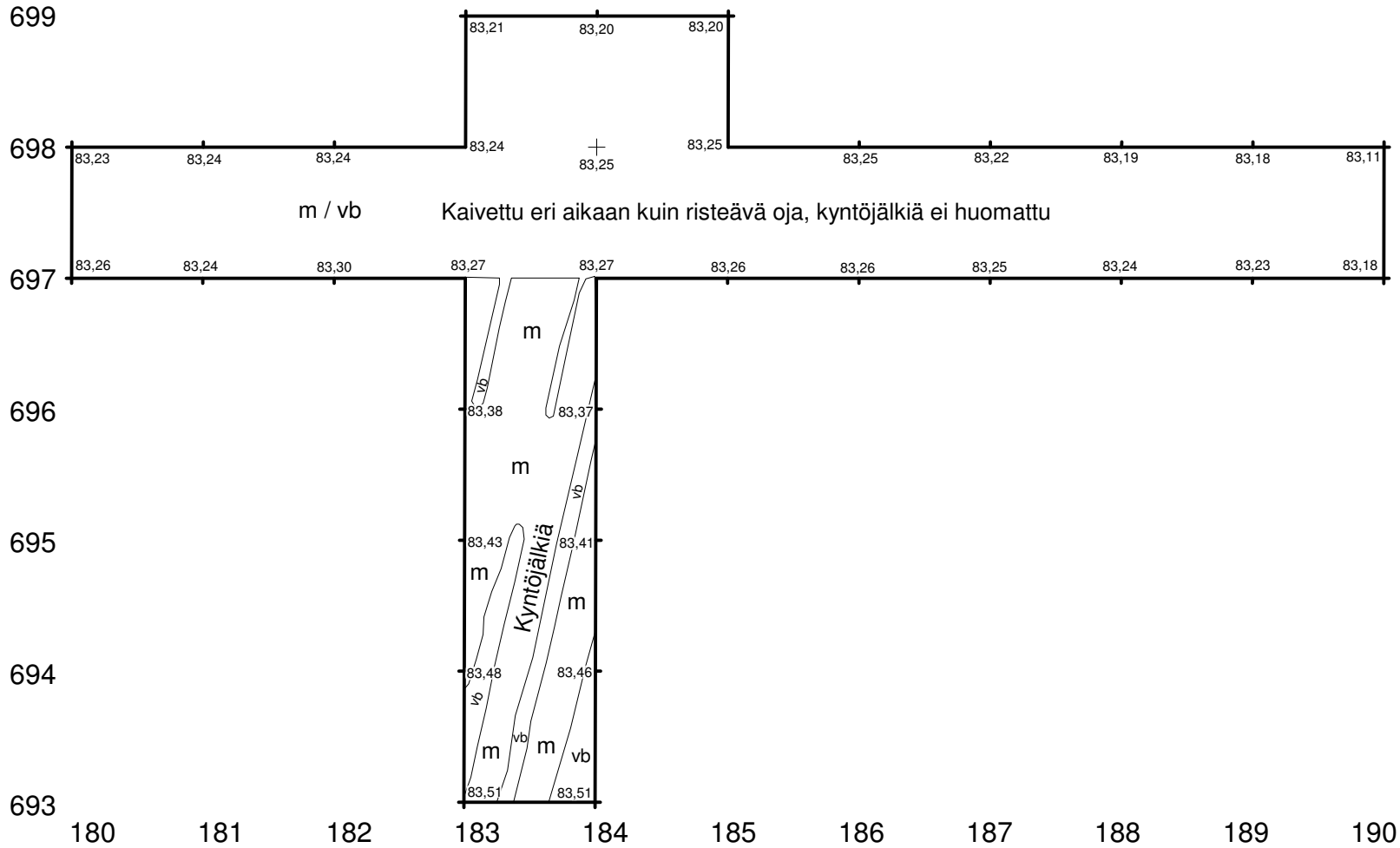

Janakkala Vähä-Hiisi 2 b  
Kreetta Lesell 2008

Pylväs 124  
Alue II  
Taso 1



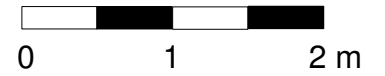

Kp korkeus 83,57 m mpy

MK 1 : 50

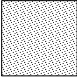

Piirt. & digit.  
Mikko Suha



-  Mullan värjäämä hiekka
-  Multa
-  Rikastumiskerros
-  Vaaleampi rikastumiskerros

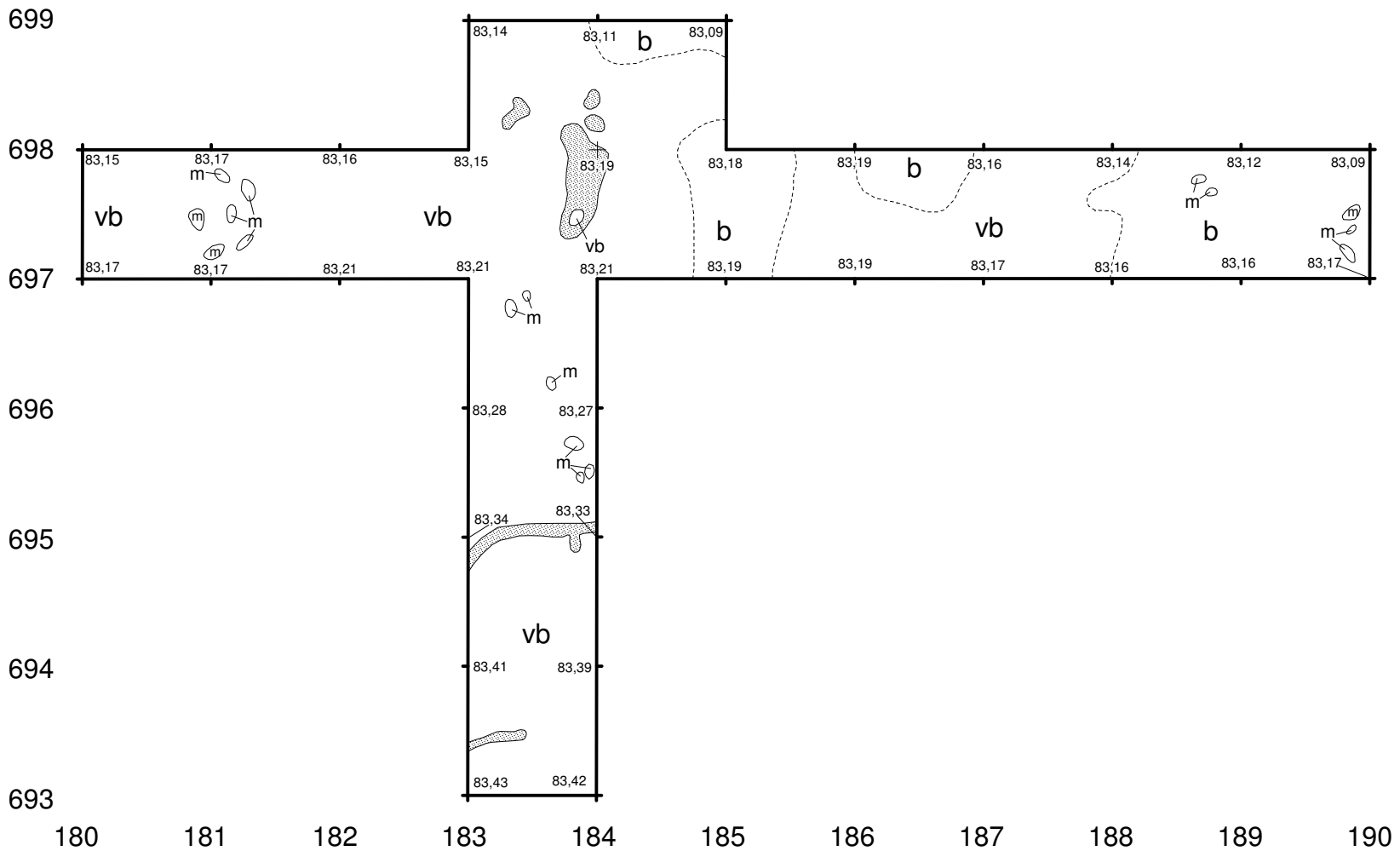



Janakkala Vähä-Hiisi 2 b  
Kreetta Lesell 2008

Pylväs 124

Alue II

Taso 2

KP korkeus 83,57 m mpy

MK 1: 50

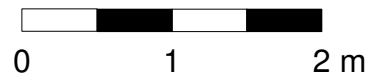

Piirt. & digit.  
Mikko Suha

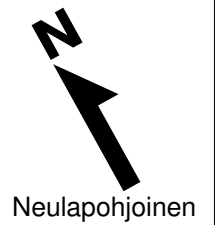

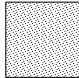
 Mullan värjäämä tumma hiekka

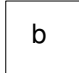
 Rikastumiskerros

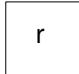
 Ruostesaostuma

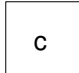
 Harmahtava pohjahiekka

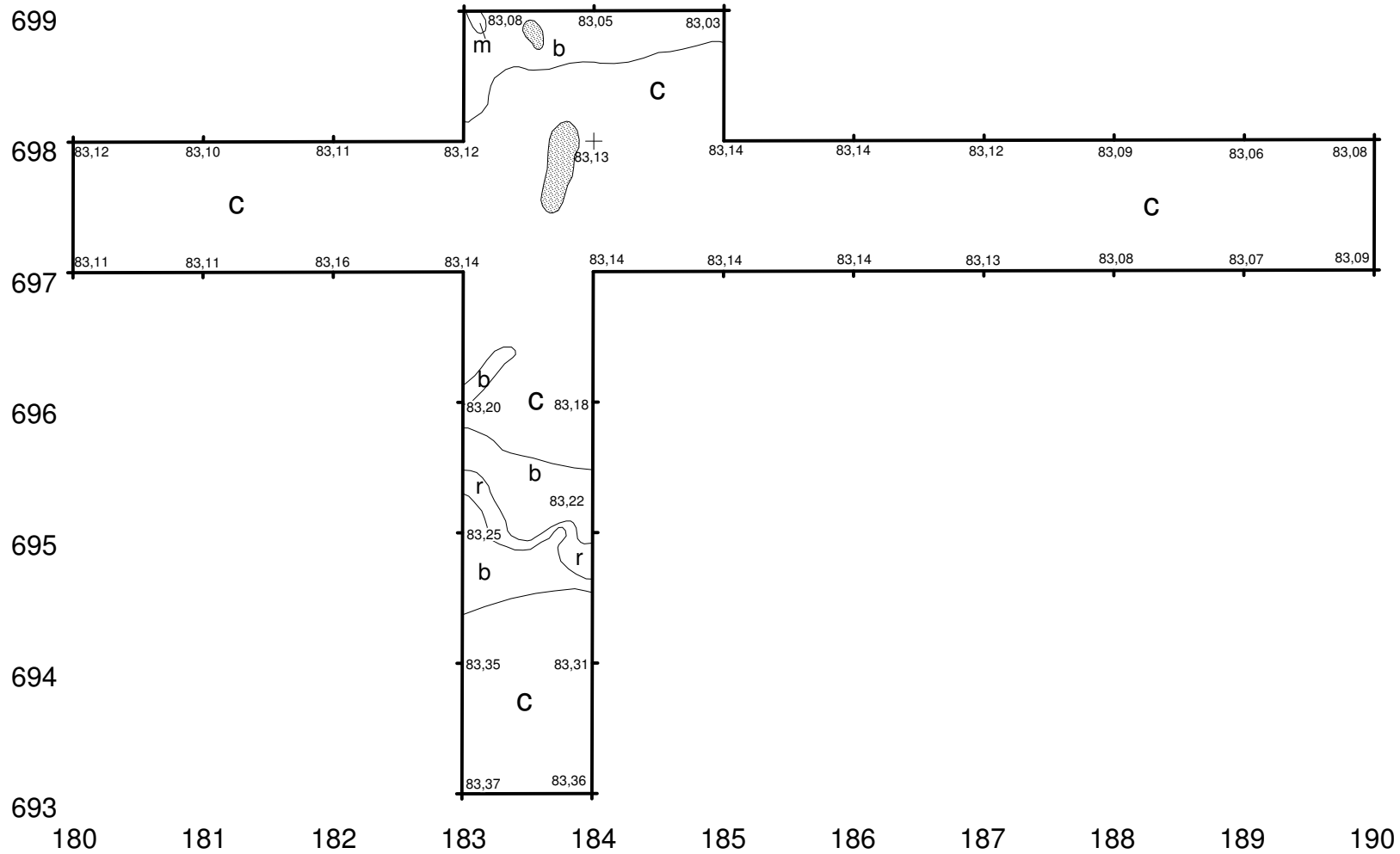

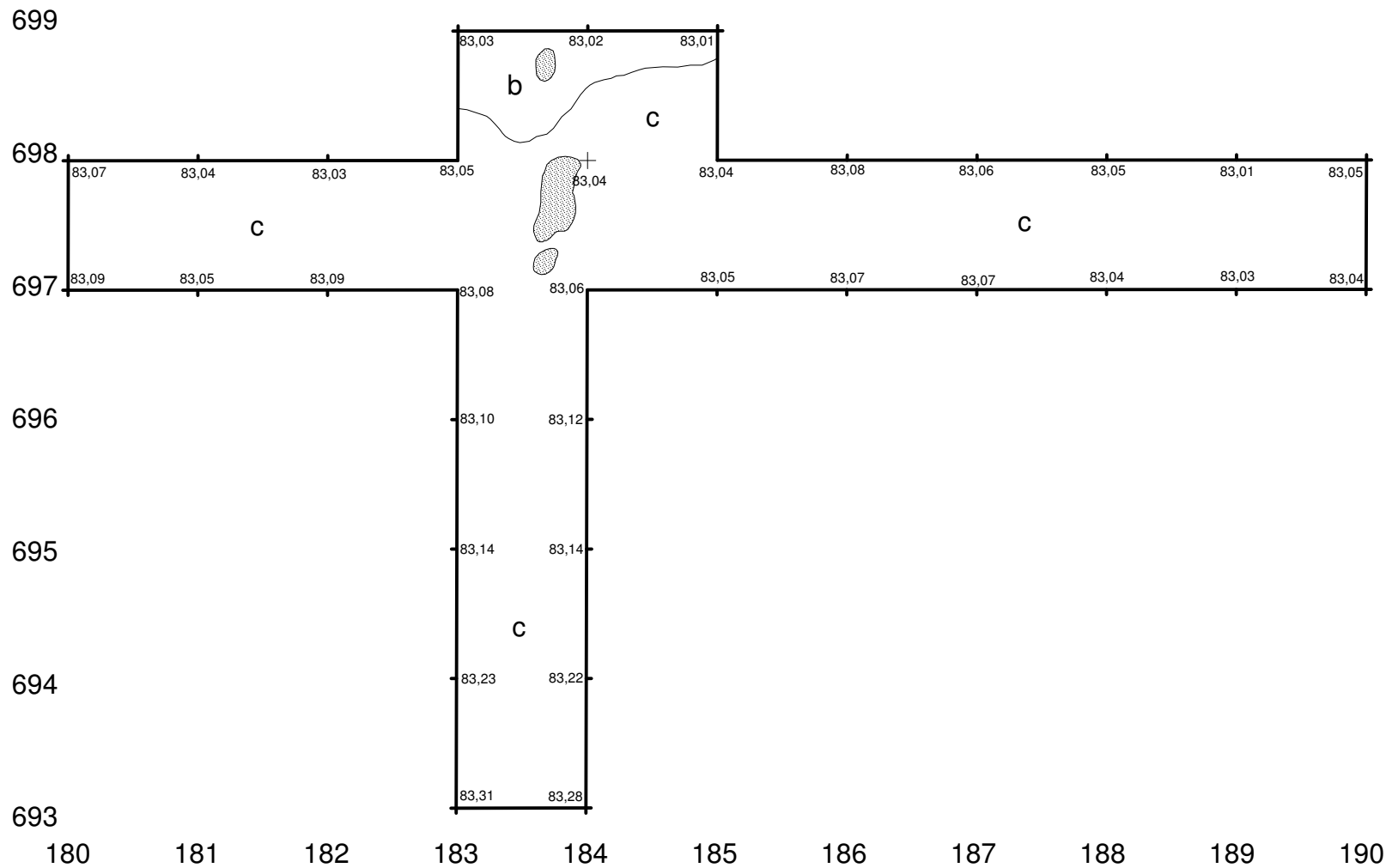

Janakkala Vähä-Hiisi 2 b  
Kreetta Lesell 2008

Pylväs 124  
Alue II  
Taso 3

Kp korkeus 83,57 m mpy

MK 1: 50

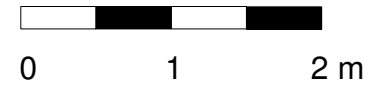

Piirt. & digit.  
Mikko Suha

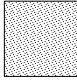
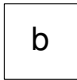
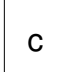

-  Mullan värjäämä tumma hiekka
-  Rikastumiskerros
-  Harmahtava pohjahiekka

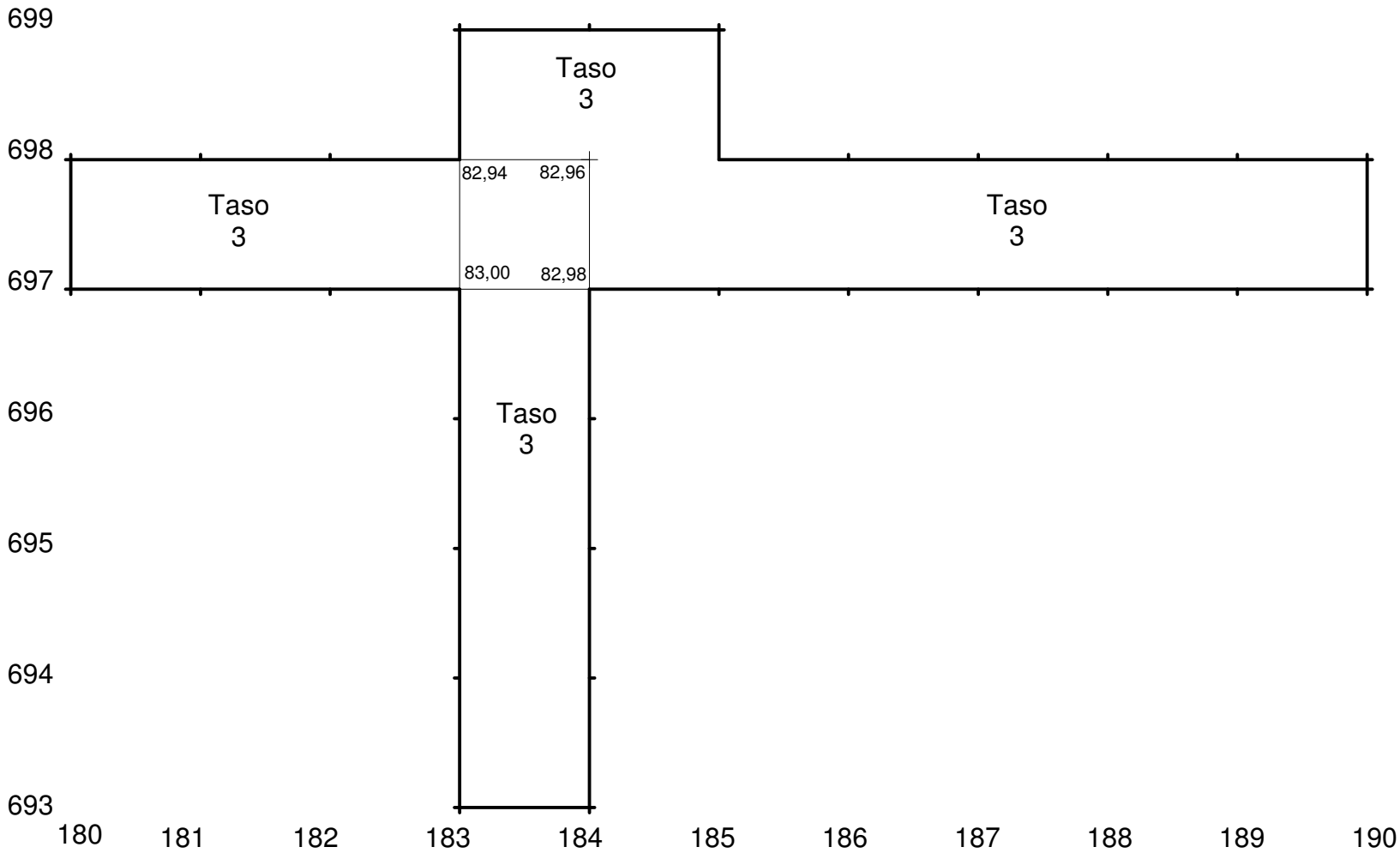

Janakkala Vähä-Hiisi 2 b  
Kreetta Lesell 2008

Pylväs 124  
Alue II  
Taso 4, vain ruutu 697 / 183

Kp korkeus 83,57 m mpy

MK 1: 50

0 1 2 m

Piirt. & digit.  
Mikko Suha

Neulapohjoinen

Janakkala Vähä-Hiisi 2 b  
Kreetta Lesell 2008

Pylväs 124  
Alue III  
Pintavaaitus

KP korkeus 83,57 m mpy

MK 1: 50

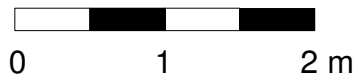

Neulapohjoinen

Piirt. & digit.  
Mikko Suha

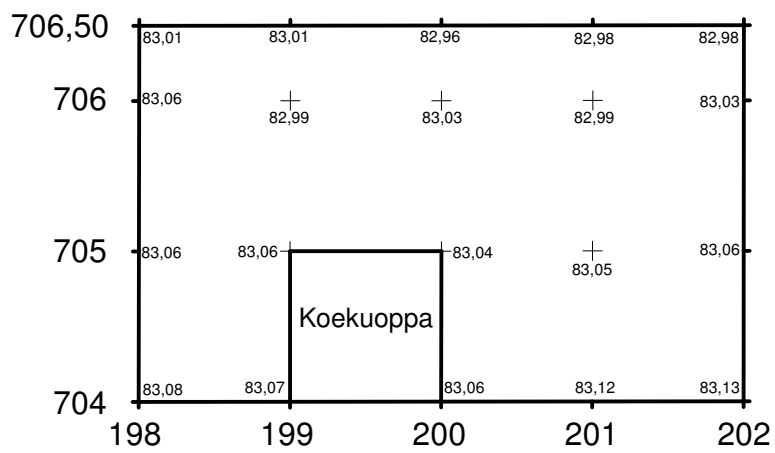

Janakkala Vähä-Hiisi 2 b  
Kreetta Lesell 2008

Pylväs 124  
Alue III  
Taso 0

KP korkeus 83,57 m mpy

MK 1: 50



m Peltomulta

vb Vaaleahko rikastumiskerros

Piirt. & digit.  
Mikko Suha

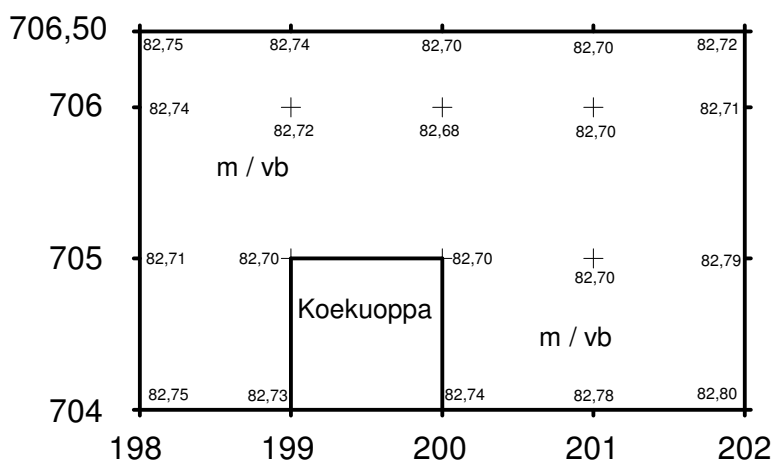

Janakkala Vähä-Hiisi 2 b  
Kreetta Lesell 2008

Pylväs 124  
Alue III  
Taso 1



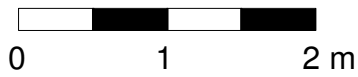

KP korkeus 83,57 m mpy

MK 1: 50

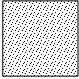

Piirt. & digit.  
Mikko Suha



-  Mullan värjäämä tumma hiekka
-  Rikastumiskerros
-  Vaaleahko rikastumiskerros
-  Peltomulta
-  Nokiläikkä

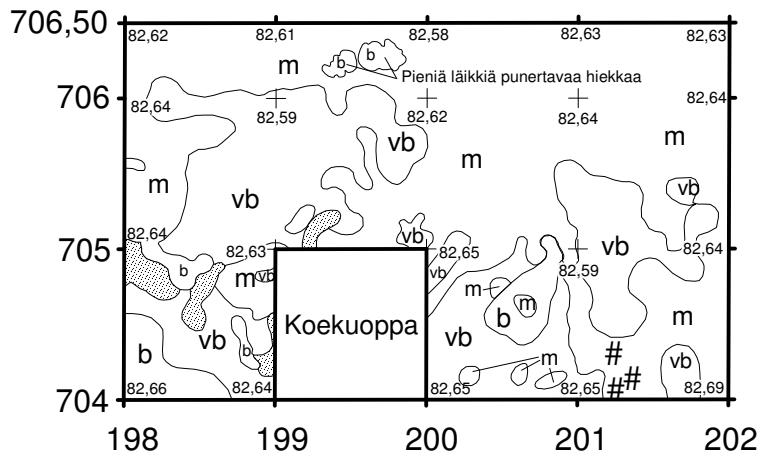

Janakkala Vähä-Hiisi 2 b  
Kreetta Lesell 2008

Pylväs 124  
Alue III  
Taso 2

KP korkeus 83,57 m mpy

MK 1: 50

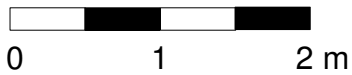

Piirt. & digit.  
Mikko Suha

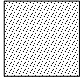

 Mullan värjäämä tumma hiekka

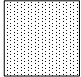
 Vaalean harmahtava hiekka

 Rikastumiskerros

 Vaalea rikastumiskerros

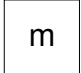
 Peltomulta, myyränkoloja yms.

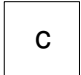
 Harmaa pohjahiekka

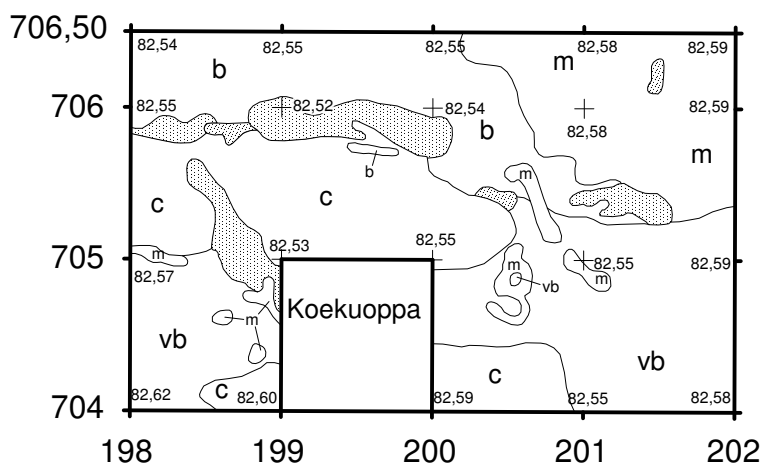

Janakkala Vähä-Hiisi 2 b  
Kreetta Lesell 2008

Pylväs 124  
Alue III  
Taso 3



KP korkeus 83,57 m mpy

MK 1: 50



Piirt. & digit.  
Mikko Suha

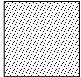
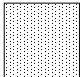

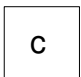
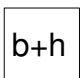
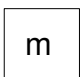
-  Mullan värjäämä tumma hiekka
-  Vaalea harmaa hiekka
-  Rikastumiskerros
-  Rikastumiskerros, vaaleampi maa
-  Harmahtava pohjahiekka
-  Rikastumiskerros + harmahtava hiekka
-  Peltomulta, myyränkoloja yms.

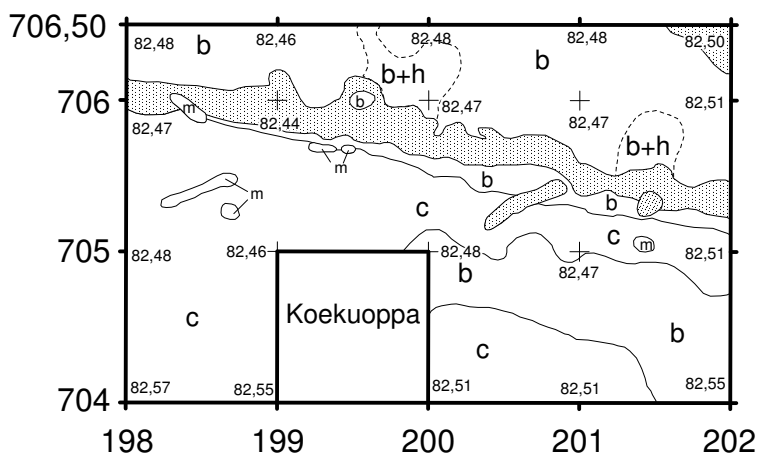



Janakkala Vähä-Hiisi 2 b  
Kreetta Lesell 2008

Pylväs 124  
Alue III  
Taso 4

KP korkeus 83,57 m mpy

MK 1: 50

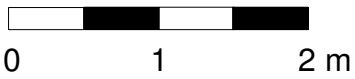

Piirt. & digit.  
Mikko Suha



Vaaleahko harmaa hiekka



Mullan värjäämä tumma hiekka



b

Rikastumiskerros



c

Harmahtava pohjahiekka



m

Peltomulta, myyränkolo

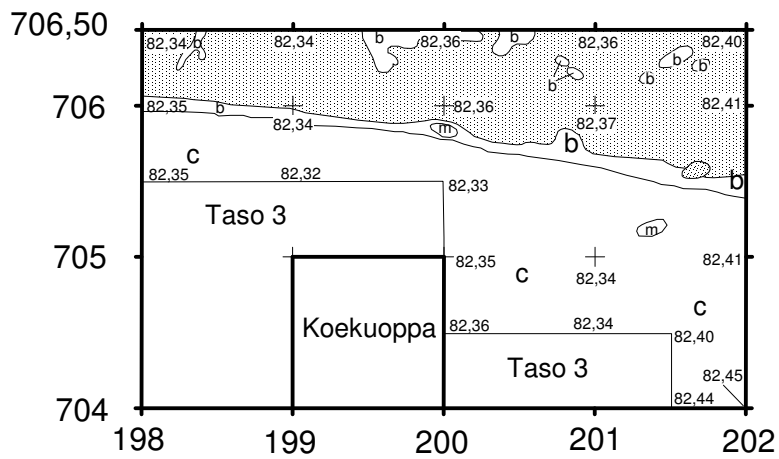

Janakkala Vähä-Hiisi 2 b  
Kreetta Lesell 2008

Pylväs 124  
Alue III  
Pohjavaaitukset

Kp korkeus 83, 57 m mpy

MK 1: 50



Neulapohjoinen

Piirt. & digit.  
Mikko Suha

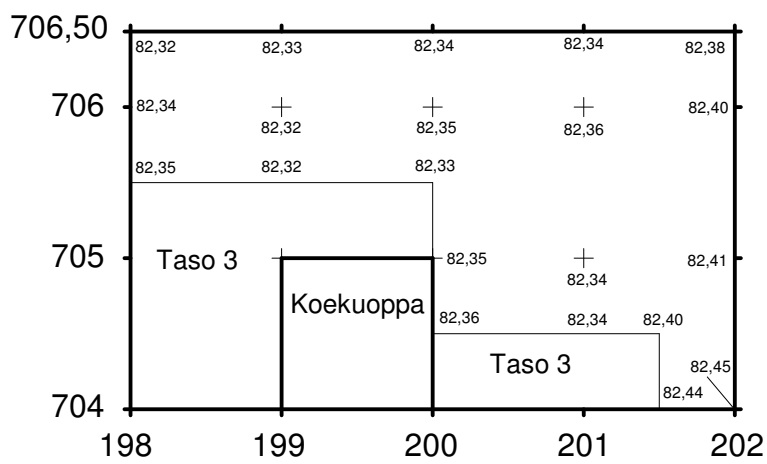

Janakkala Vähä-Hiisi 2 b  
Kreetta Lesell 2008

Pylväs 124  
Alue III  
Koillisprofiili linjalla X: 706,50  
Katselusuunta lounaasta

Kp korkeus 83, 57 m mpy

MK 1: 25

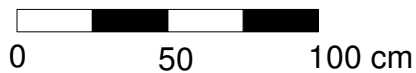

Piirt. & digit.  
Mikko Suha

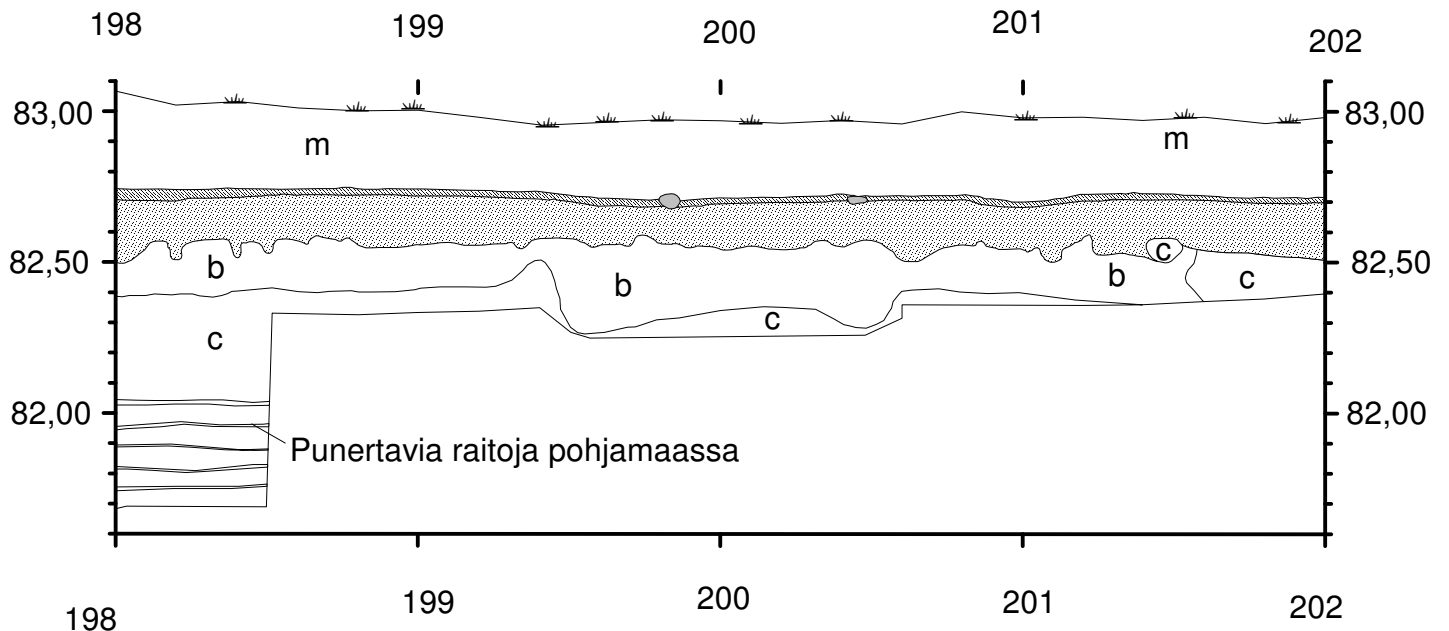
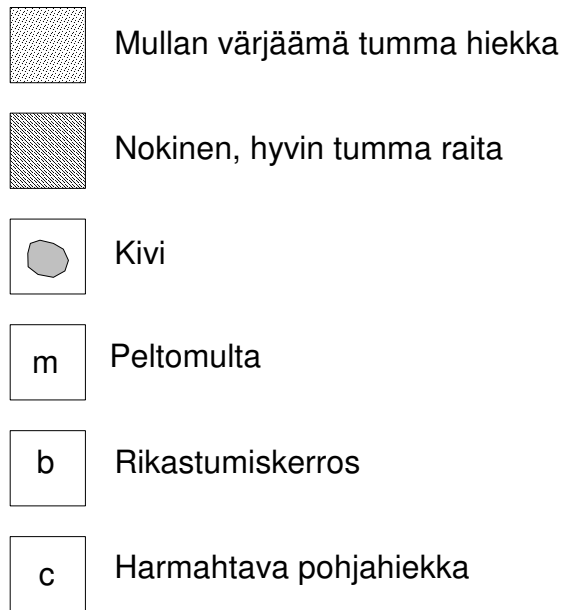

Janakkala Vähä-Hiisi 2 b  
Kreetta Lesell 2008

Pylväs 124  
Koekuoppa 704 / 199  
Lounaisprofiili linjalla X: 704  
Katselusuunta koillisesta

Kp korkeus 83, 57 m mpy

MK 1: 25

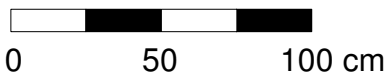

Piirt. & digit.  
Mikko Suha



Hiiltä sisältävä peltokerros, tumma



Heikko ruskeahko likamaa



Peltomulta



Harmahtava pohjahiekka

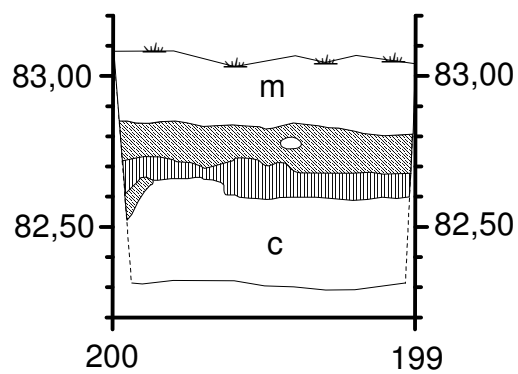

**Janakkala Vähä-Hiisi 1, 2 a & 2 b  
Kreetta Lesell 2008**

Yleiskartta koko alueesta, pylväät 121-124

MK 1: 2000

0 100 m

Piirt. & digit.  
Mikko Suha

Neulapohjoinen

-  Rakennus
-  Voimalinjapylväs
-  Tulevan voimalinjapylvään keskikohta
-  Kaivausalue, koekuoppa
-  Rinne, viettosuunta
-  Inventoinnissa määritelty löytöalue nimineen (Saukkonen 1984)
-  Uusi ehdotus muinaisjäännösalueiden laajuuksiksi
-  alakohteet

